

Calypso

RM3500ZB

Installation Guide

Smart Water Heater Controller

sinopé

zigbee 3.0

INSTALL YOUR CONTROLLER ON A WATER HEATER

- Hardware required for installation**
 - 1 standard utility electrical wiring box - with conduit knockouts, 4" x 4" x 1-1/2" deep
 - 1 electrical box cover
 - 2 wire clamps

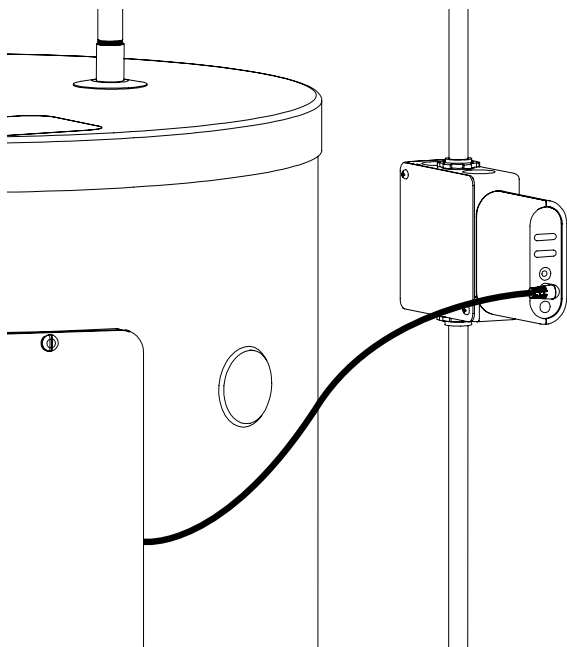

Warning

The installation of this controller must be made by a certified electrician and must be installed in conformity with the national and local electrical codes.

The smart water heater controller is designed for indoor use only.

YOUR CALYPSO CONTROLLER

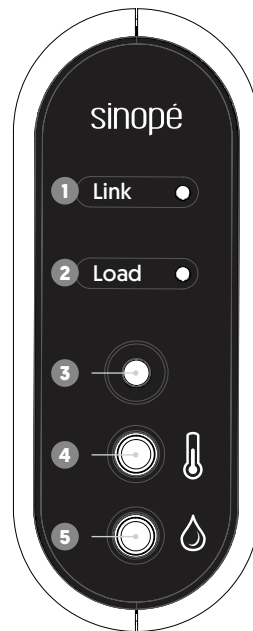

- "Link" Indicator**
The indicator lights up when the controller is connected to the network.
- "Load" Indicator**
The indicator lights up when power is applied to the water heater.
- ON / OFF Button**
- Temperature Probe Port**
This temperature sensor guarantees maximum comfort and a minimum temperature threshold during your power utility's peak management events.*
- Water Detection Cable Port**
The optional water detection cable detects potential leaks, sends an alert on your mobile device, and can turn off the water heater power when a leak is detected by using an automation.

* Nevibeb account and Éco Sinopé participation required.

TECHNICAL SPECIFICATIONS

Operating voltage: 120 V - 240 V [60 Hz]

Maximum load: 20.8 A @ 240 Vac
Single-pole relay

Operating temperature: 0 °C to 40 °C [32 °F to 104 °F]

Storage: -20 °C to 50 °C [-4 °F to 122 °F]

Standard UL: Conforms to ANSI/UL Std. 916
Certified under CAN/CSA Std. C22.2 No205

Indoor installation only

Zigbee 3.0 profile

Frequency: 2.4 GHz

Transmission power: +20 dBm

Receiver sensitivity: -108 dBm

Note: If your water heater has been turned off for several days, it is recommended to wait until the water temperature has reached 60 °C [140 °F] for 4 hours and then let the hot water run for a few minutes before using it.

INSTALLATION ON A 240 V CIRCUIT

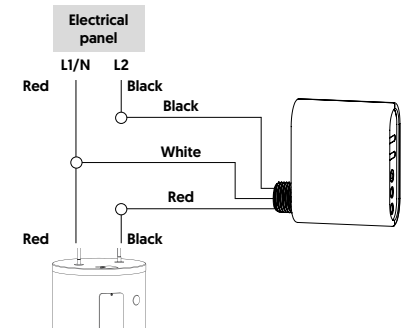

INSTALLATION ON A 120 V CIRCUIT

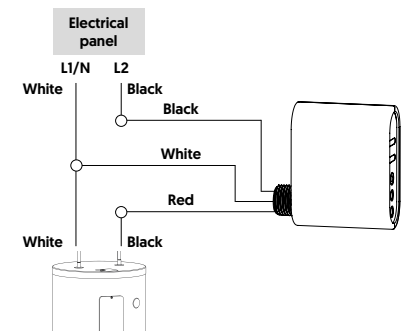

How the protection mechanism works

As a protective measure, the controller is designed to restart the water heater if the water temperature drops below 45°C [113°F], even if the controller is not connected to a gateway.

If the temperature sensor is not installed, the protection will no longer apply and the water heater can then remain off for a longer period.

It is possible to deactivate the protection in the Nevibeb app.

INSTALLING THE TEMPERATURE PROBE

- 1 Unscrew and remove the door plate located at the top of the water heater.

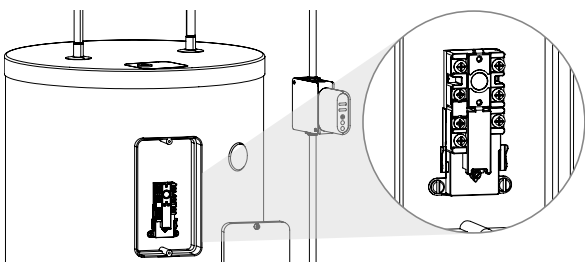

- 2 Plug the probe into the controller's temperature port.

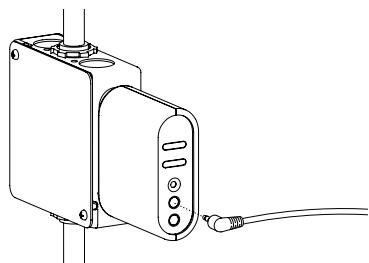

- 3 Remove the sticker liner from the end of the probe and affix it to either side of the water heater's thermostat, as illustrated. Screw the water heater door plate in place. Note: Clean the side of the thermostat with isopropyl alcohol before affixing the probe.

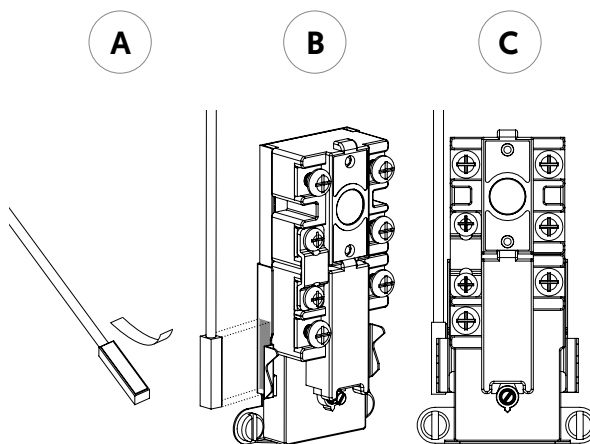

- 4 Make sure to adjust the water heater's temperature between 55°C (131°F) and 60°C (140°F) to use the controller during your power utility's peak management events.

INSTALLING THE OPTIONAL AC4200C-02 WATER DETECTION CABLE

You can add a water detection cable to the water heater controller that can shut off its power as soon as a leak is detected.

- 1 Plug the water detection cable into the controller's lower port.

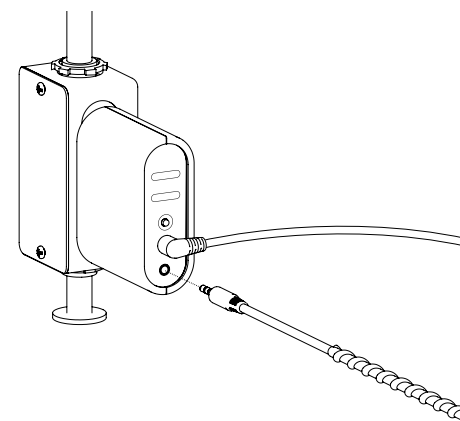

- 2 Position the water detection cable at the base of the water heater and secure its position with the provided fasteners.
- 3 Power up the controller.

ADD YOUR CONTROLLER TO THE NEVIWEB APP

- 1 If you do not have an account yet, download the Neviweb app for iOS or Android to create an account and add your device.



Get the app



- 2 Tap , then select "Add Device".
- 3 Follow the steps of the installation wizard.

Neviweb® is a registered trademark of Sinopé Technologies Inc. in Canada and the United States.

App Store is a service mark of Apple Inc., registered in the U.S. and other countries.

Google Play and the Google Play logo are trademarks of Google Inc.

CONNECT YOUR CONTROLLER TO THE GT130 GATEWAY OR A COMPATIBLE ZIGBEE SYSTEM

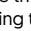
- 1 Initiate the connectivity session by pressing the RF signal button  on the GT130 gateway. The indicator light will start flashing.



- 2 Connect the controller to your network by pressing the ON/OFF button for 3 seconds.

Link LED status	Connection status
Blinking green	The controller connects.
Green remains ON	The controller is connected.
Stays on red for 10 sec	Connection failed*

*Refer to the «Support» section of our Website at www.sinopetech.com.



- 3 Connect all your compatible Zigbee devices the same way by going to the next closest device.



- 4 When all your devices are connected, close the connectivity session of your GT130 gateway or your compatible Zigbee gateway.



Transmitter module: FCC ID: QOQGM210P / IC: UC 5123A-GM210P
FCC CFR 47 Title 15 Class B

This device complies with Industry Canada license exempt RSS standard[s]. Operation is subject to the following two conditions:
[1] this device does not cause interference, and [2] this device must accept any interference, including interference that may cause undesired operation of the device.

This equipment has been tested and found to comply with the limits for a Class B digital device, pursuant to part 15 of the FCC Rules. These limits are designed to provide reasonable protection against harmful interference in a residential installation. This equipment generates, uses and can radiate radio frequency energy, and if not installed and used in accordance with the instructions, may cause harmful interference to radio communications. However, there is no guarantee that interference will not occur in a particular installation. If this equipment does cause harmful interference to radio or television reception, which can be determined by turning the equipment OFF and ON, the user is encouraged to try to correct the interference by one or more of the following measures:

- Reorient or relocate the receiving antenna.
- Increase the separation between the equipment and receiver.
- Connect the equipment into an outlet on a circuit different from that to which the receiver is connected.
- Consult the dealer or an experienced radio/TV technician for help.

3-year limited warranty

SINOPÉ TECHNOLOGIES INC. warrants the components of their products against defects in material and workmanship for a 3 year period from the date of purchase, under normal use and service, when proof of purchase of such is provided to the manufacturer. This warranty does not cover any transportation costs that may be incurred by the consumer. Nor does it cover a product that has been improperly installed, misused or accidentally damaged. The obligation of SINOPÉ TECHNOLOGIES INC., under the terms of this warranty, will be to supply a new unit and this releases the manufacturer from paying the installation costs or other secondary charges linked to replacing the unit or the components.

sinopé

For more information, visit our Website:

www.sinopetech.com

